

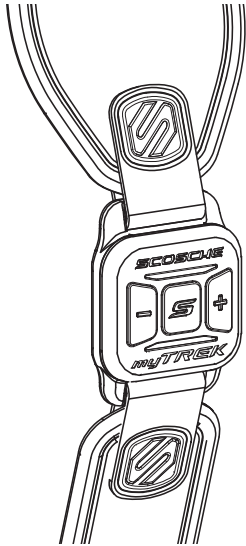

WIRELESS PULSE MONITOR* IPTM

For iPhone and iPod touch

USER GUIDE



PARTS INCLUDED

- (1) myTREK unit
- (1) Charging cable
- (3) Armbands (small, medium & large)
- (1) Quick-start guide

SPECIFICATIONS

Armband sizes & weight: Small: 4.3" / .20 oz.;
 Medium: 6.3" / .30 oz.; Large: 9.6" / .40 oz.
 Unit with sensor only: 5.5" / 1.05oz
 Weight with Small Armband: 1.25 oz.
 Weight with Medium Armband: 1.35 oz.
 Weight with Large Armband: 1.45 oz.
 Charging Cable: 38"
 Battery type: Lithium Ion
 Battery life: 5 Hours
 Water resistant (Do not submerge the Scosche myTREK in water. It is not designed for swimming or underwater activities)
 Operating temperature: 0°C to +45°C / 30°F to 113°F
 Storage temp: -20°C to +60°C / -4°F to 140°F

*Patent Pending

CONTENTS

LANGUAGE	PAGES
English	x
French (Français).....	x
French-Canadian (Français-Canada)	x
German (Deutsch).....	x
Chinese (中國語文).....	x
Spanish (Español).....	x
Italian (Italiano).....	x
Japanese (日本語).....	x

HEALTH WARNING

This is not a medical device and is intended for recreational use only. No claims are made or implied in the results obtained by the use of our equipment. Consult a physician prior to undertaking any physical activity with the SCOSCHE® myTREK. Do not rush into an advanced workout with the SCOSCHE® myTREK unless you have significant exercise experience and no history of medical illness due to exertion or other fitness related health problems.

This device, the SCOSCHE® myTREK pulse monitor, and other SCOSCHE® accessories are consumer devices, not medical devices, and could suffer interference from external electrical sources. The pulse readings are for reference only, and no responsibility is accepted for the consequences of any erroneous readings.

BATTERY WARNINGS

This product contains a rechargeable lithium battery that should only be removed and replaced by a professional. Battery can explode or leak and cause injury if removed by the user and crushed, installed backwards or exposed to excessive heat. Keep out of reach of children and dispose of properly. If swallowed promptly contact a doctor and call your local poison control center.

DISCLAIMER

Scosche Industries shall not be liable for any incidental or consequential damages resulting from the performance or use of this product.

In the interest of continued product improvement, this company reserves the right to revise the manual or include changes in the specifications of the product described within it at any time without notice and without obligation to notify any person of such revision or changes. The information contained in this manual is provided for general use by the customers.

Do not attempt to remove the sensor from the actual device. This can cause damage that may render the SCOSCHE® myTREK unit inoperable.

IMPORTANT!

DO NOT RETURN PRODUCT TO THE RETAILER

IF YOU NEED ASSISTANCE OR REPLACEMENT PARTS

CALL US TOLL FREE: 1-800-621-3695 X3

HOURS MON-FRI 8AM-5:30PM (PST) SATURDAY 8AM-2PM (PST)

iPhone and iPod touch are trademarks of Apple Inc., registered in the US and other countries.

myTREK DEVICE OVERVIEW & CHARGING

HOW SCOSCHE® myTREK WORKS

Blood is constantly moving through the human body and consequently the amount of blood under the skin at any given point is constantly changing. The main forces of blood movement are the heart pumping and physical body movements. SCOSCHE® myTREK armband detects blood movement by shining light onto the skin and measuring the amount of light that is absorbed by the skin. In addition myTREK uses an accelerometer similar to what is used in popular gaming controllers to detect body movement and then subtracts the movement from the light measurement. All of the data collected from this process is sent to the user's iPhone or iPod touch for further filtering and signal processing. The final output is displayed on the iPhone or iPod touch as the users pulse.

SENSOR ACCURACY

Testing within Scosche Industries has shown the average pulse rate to be within +/- 3% of a chest strap.

myTREK's USE OF GPS

myTREK uses the GPS that is built into iPhone. By knowing a users position the myTREK App can calculate distance traveled and average speed during a workout. The higher the GPS signal strength the more accurate the results. The myTREK App has a GPS signal strength indicator with the following levels of accuracy:

- No blue dots means the GPS accuracy is less than 50 meters and the App will not calculate distance or speed during the workout.
- 1 Blue dot means the GPS accuracy is greater than 50 meters.
- 2 Blue dots means the GPS accuracy is greater than 30 meters.
- 3 Blue dots means the GPS accuracy is greater than 10 meters.

CHARGING

Charge the SCOSCHE® myTREK for 2 hours or until a solid green light indicates the unit is fully charged.

1. Attach the charging base to the SCOSCHE® myTREK unit (see Figure 1).
2. Connect the USB to a wall charger or your computer.
3. A red flashing LED indicates that the unit is charging.

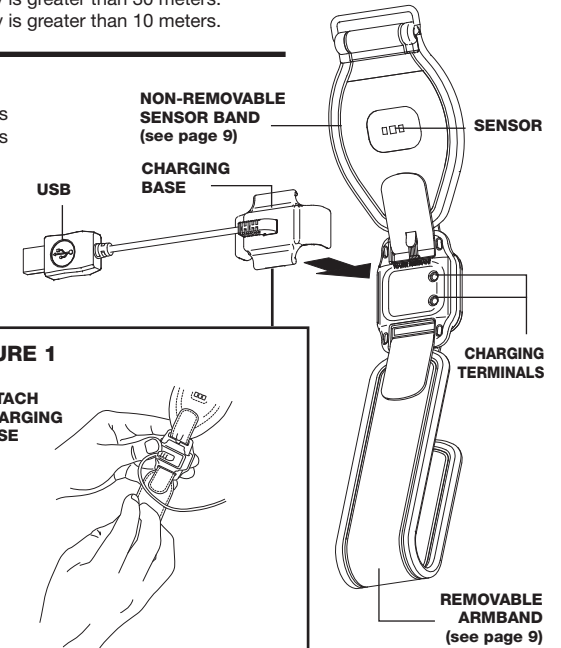
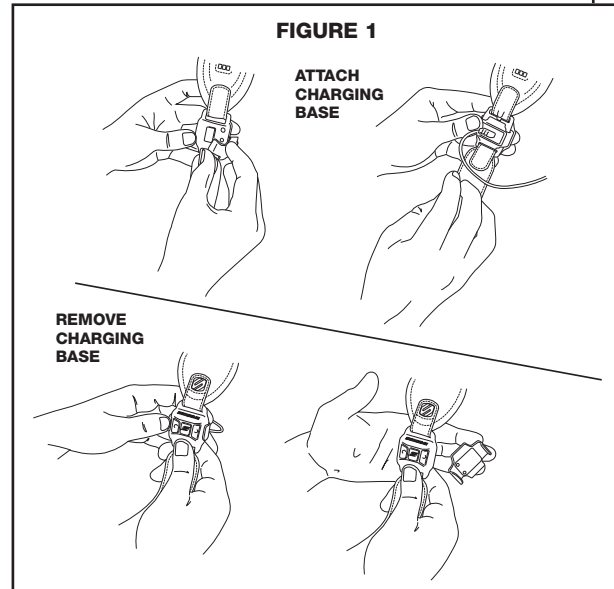
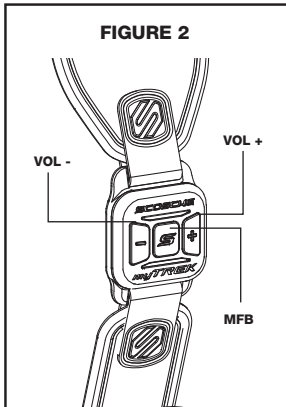

FIGURE 1



myTREK PAIRING & INTIAL SETUP OVERVIEW



INITIAL SETUP

1. On the iPhone or iPod touch, go to Settings > General > Bluetooth. Turn on Bluetooth.
2. Turn on the SCOSCHE® myTREK by pressing the MFB (Multi Function Button - center button labeled 'S') once (Figure 2).
3. The SCOSCHE® myTREK will enter pairing mode and will show up under Devices. Press "myTREK" to pair with iPhone or iPod touch.
4. Once paired, the iPhone or iPod touch should ask you to download the SCOSCHE® myTREK App (see left). Please do so to continue. If the iPhone or iPod touch does not prompt you, open the App Store, and search for "myTREK".
5. While the App is downloading, attach the SCOSCHE® myTREK to either arm. The unit includes removable armbands in 3 sizes. See CARE & MAINTENANCE page 9 for more information. For best performance position the SCOSCHE® myTREK on the inside of the forearm (Figure 3). Make sure it is securely attached. **IMPORTANT:** The strap should be worn snug enough not to move on your arm, but NOT so tight that it restricts arm circulation
6. Once the App is downloaded, press the SCOSCHE® myTREK App to start. "First Steps" guide will appear when the App has launched (see below).



BUTTON FUNCTIONS ON THE SCOSCHE®

myTREK (Figure 2)

- Volume minus (-) will lower the volume if you are playing music.
 - Volume plus (+) will raise the volume if you are playing music.
 - Press MFB once to start playing music. Press again to stop playing music. Press twice quickly to skip to the next track. Press three times quickly to skip to the previous track.
- NOTE:** The MFB functions are for in-App use only (see below).

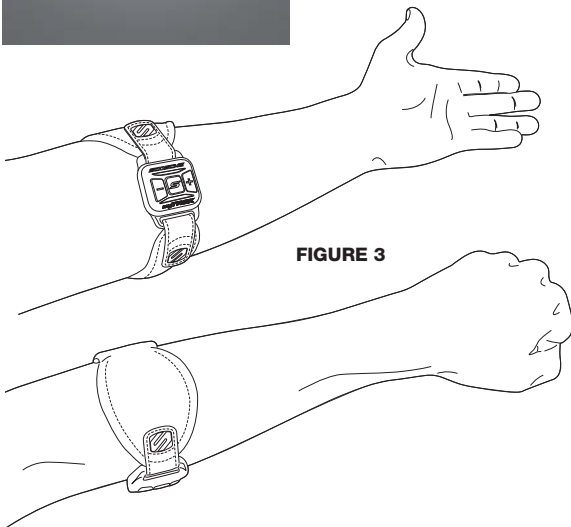
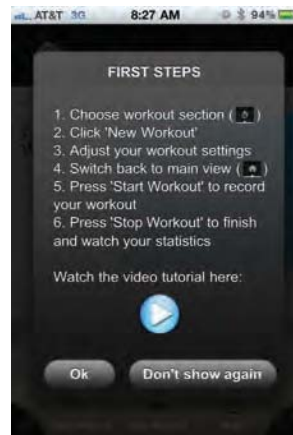
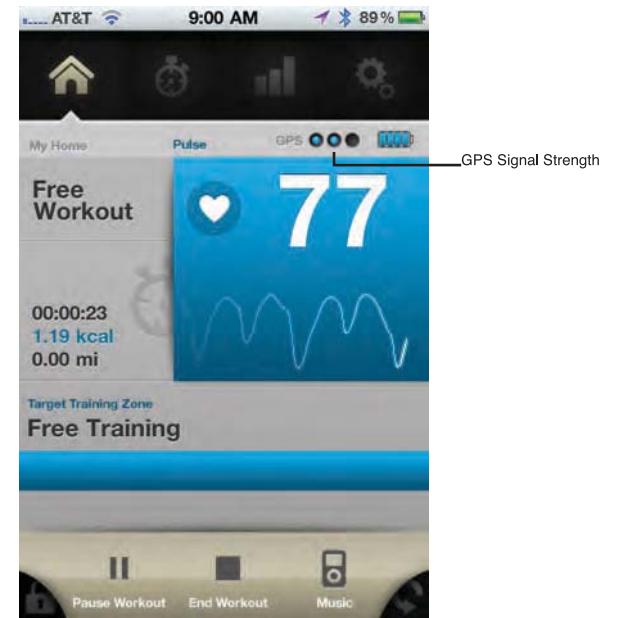

FIGURE 3



myTREK APP OVERVIEW



myTREK APP CALIBRATION & USER SETTINGS

CALIBRATING

The App will calibrate itself with the SCOSCHE® myTREK device. Once calibrated it will show a visual representation of your pulse.

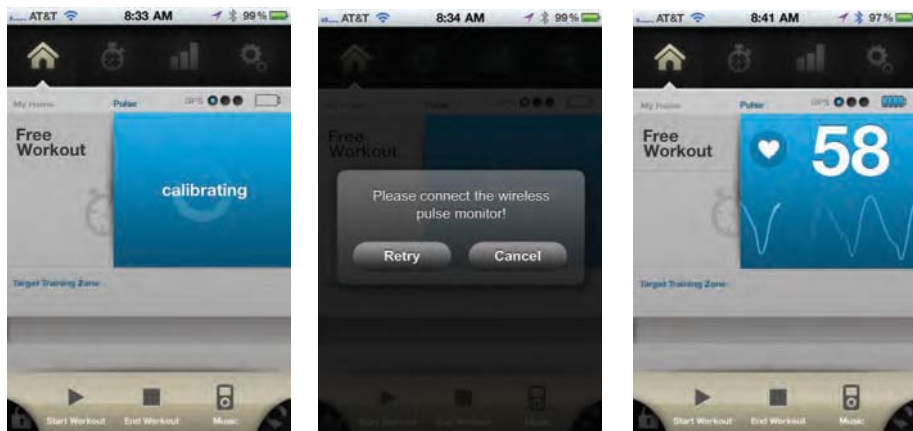

ENTERING IN USER SETTINGS

1. Enter in your Date of Birth. **Note:** Your Maximum Heart Rate will be determined by your DOB.
2. Enter in your Gender.
3. Enter in your Weight.
4. **How to find your resting heart rate:** It is best to find your Resting Heart Rate before you start any significant activities.
 - a. Find your pulse at your wrist (the radial artery) or at your carotid artery in your neck.
 - b. Using your index and middle finger, count the number of beats you feel in 10 seconds. Do not use your thumb since it has a light pulse that can confuse you while counting.
 - c. Multiply the number of beats you count in 10 seconds by six to find the number of beats per minute. You can take your pulse three times, and then take the average rate of all three to get a more accurate result.
5. Enter the desired Units of Measurement.
6. Enter the type of Voice Prompt you would like to hear (male/female).

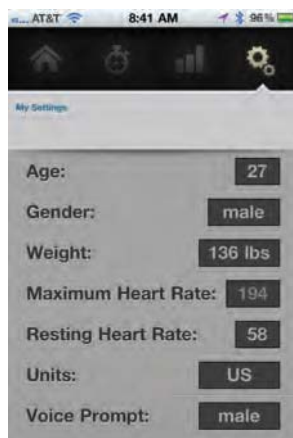

myTREK USER SETTINGS & SETTING UP WORKOUTS

ENTERING IN USER SETTINGS (cont'd)

7. Adjust the sound volume.
8. Select if you would like to hear sounds or not.
9. Set the Screen Lock time.
10. Select if you would like to Allow Auto-Lock or not.
11. Select if you would like to Pause your workout for Incoming Calls.

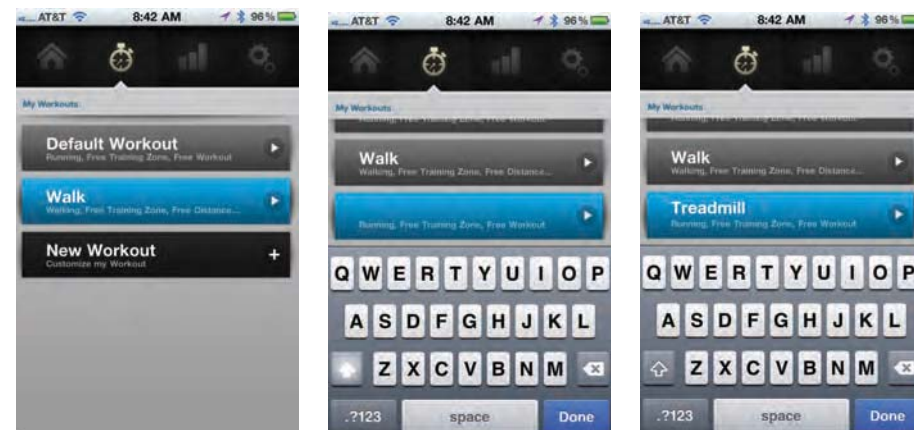
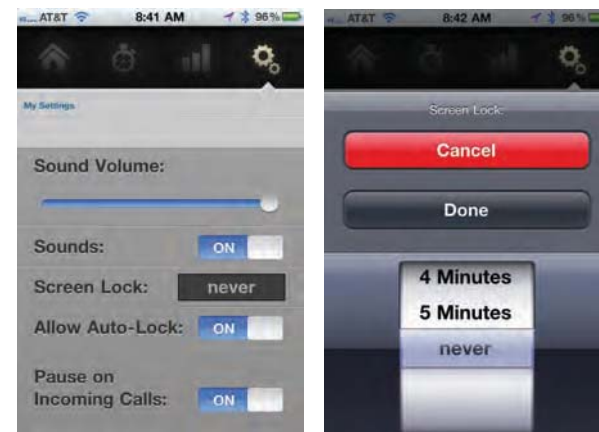

SETTING UP WORKOUTS

1. Press the My Workouts button.
2. Select the New Workout button.
3. Name your Workout.
4. Choose the Type of Activity and press the Next button.

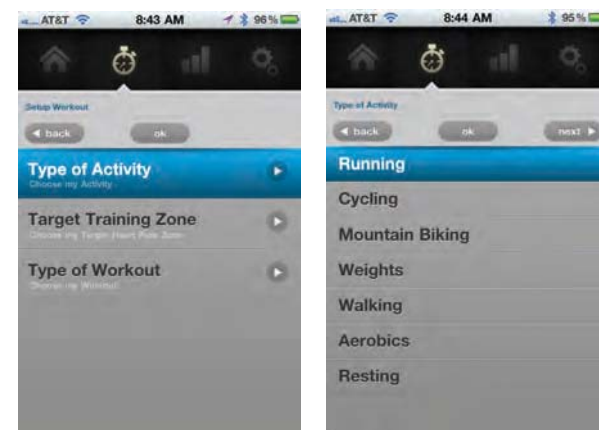

SETTING UP & STARTING WORKOUTS

SETTING UP WORKOUTS (cont'd)

5. Choose Your Target Training Zone and press the Next Button.
6. Choose the Type of Workout. Press the Ok button to finish.
7. To delete a Workout, swipe from left to right and press the delete button.



STARTING WORKOUTS

1. Choose the desired workout from the My Workouts section.
2. Press the My Home button.
3. To get started press the Start Workout button on the bottom of the screen.

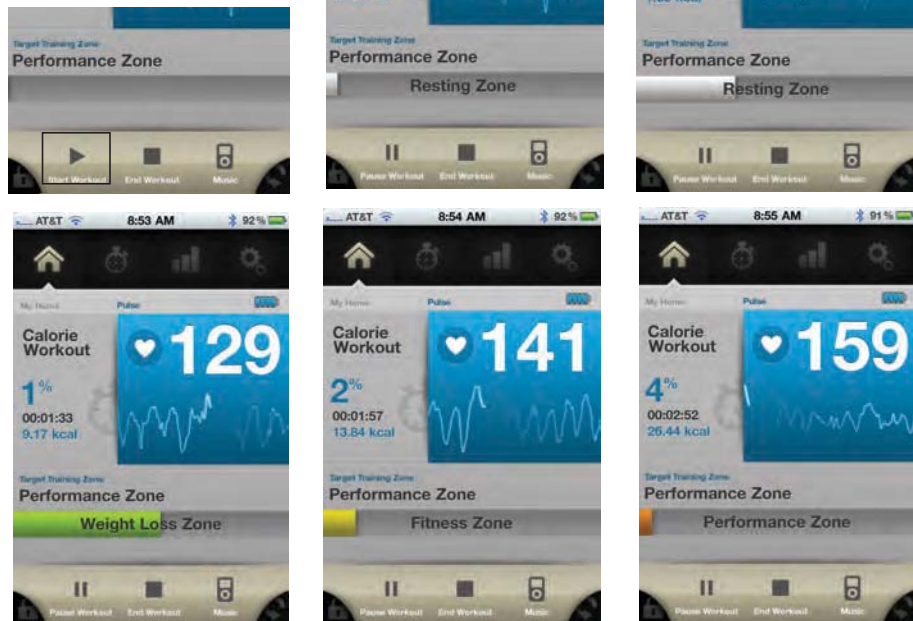

MY STATS & MUSIC PLAYER

PAUSING / ENDING WORKOUTS

1. To Pause your workout press the Pause Workout button on the bottom of the screen.
2. To Resume your workout press the Resume Workout button on the bottom of the screen.
3. To End your workout press the End Workout button on the bottom of the screen.



VIEWING STATS

Once you End your First Workout you will be taken to the My Stats page. From here you can see your workout results, including:

- Workout Name,
- Workout Time,
- Average Pulse,
- Average Speed,
- Pace,
- Calories
- Distance

Press the Back button to see a calendar view of all your previous workouts. Press the Current button to see your most current workout



USING THE MUSIC PLAYER

- You can access music from your iPod library in the **myTREK** App. Click the add button to select your desired music.
- You have the ability to shuffle, repeat all, repeat 1 or repeat none.
- You can control volume, previous/next track, start and stop from the **myTREK** unit during workout. Refer to BUTTON FUNCTIONS on the SCOSCHE® **myTREK** on page 3.

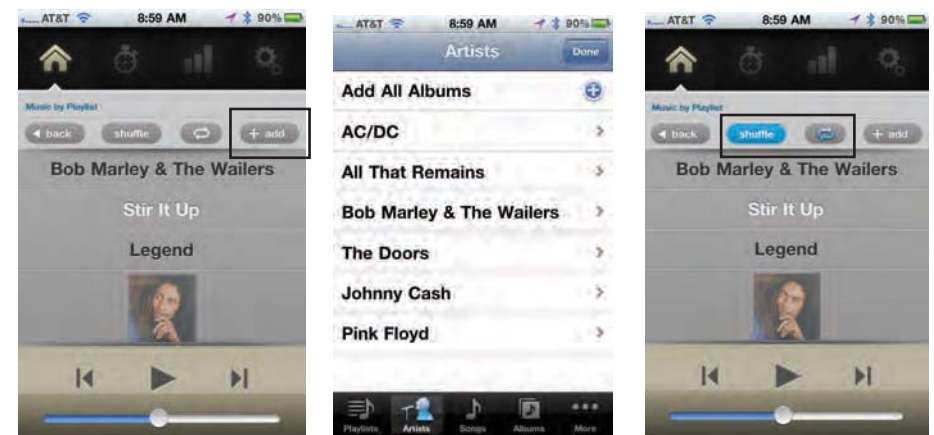

CARE & MAINTENANCE

CLEANING THE myTREK

Non-Removable Sensor Unit

Use a soft cloth with mild hand soap and cool water to wipe down the sensor, band and case. DO NOT SUBMERGE IN WATER. Let air dry.

To clean the charging contacts use a cotton swab and rubbing alcohol.

Removable Armbands

Hand wash with mild hand soap and cool water. Let air dry.

DO NOT USE ANY ABRASIVE MATERIALS TO CLEAN THE SCOSCHE® myTREK

REMOVING & CHANGING STRAPS

Unhook the armband on the bottom of the SCOSCHE® myTREK unit and replace with the desired length armband as shown in Figure 4.

SKIN SENSITIVITY

If at any time a minor skin irritation, rash or other discomfort should occur, consult your physician before continuing to use the SCOSCHE® myTREK.

STORING THE UNIT

Keep in a cool dry place away from high heat, extreme cold and moisture.

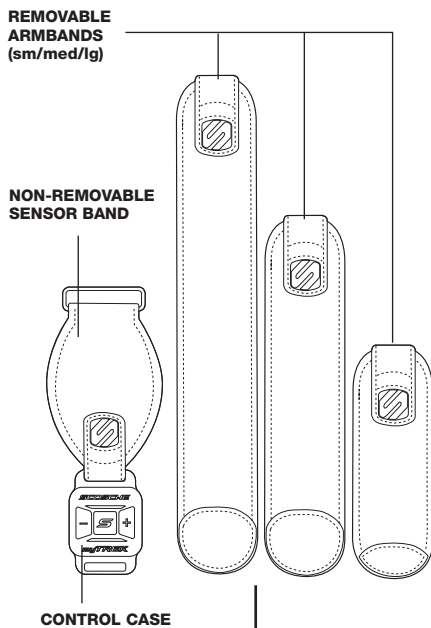
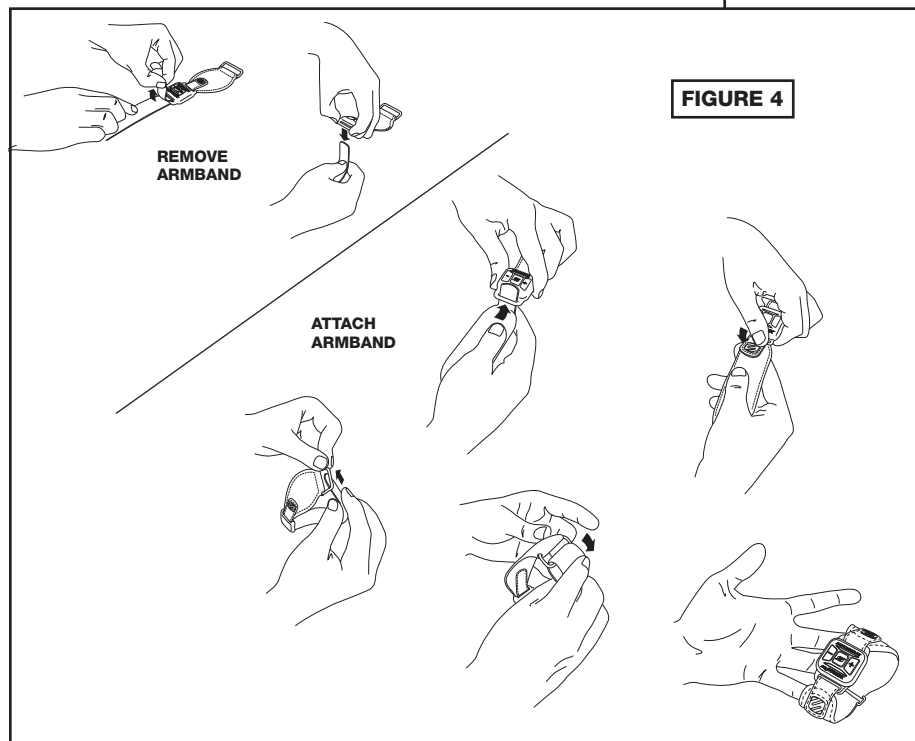

FIGURE 4



SCOSCHE® myTREK™ App - Legal End User License Agreement

IF YOU DOWNLOAD THE SOFTWARE SUBJECT TO THESE TERMS BY CLICKING THE 'I AGREE' BUTTON, AND/OR USE THE SCOSCHE myTREK™ SOFTWARE OR ANY INCLUDED DOCUMENTATION (together the "Software"), YOU AGREE TO BE BOUND BY THE TERMS AND CONDITIONS OF THIS AGREEMENT (the "Agreement"), AND THIS WILL BE A LEGALLY BINDING AGREEMENT BETWEEN YOU AND SCOSCHE INDUSTRIES, INC. ("SCOSCHE INDUSTRIES"). SCOSCHE INDUSTRIES MAY AMEND THIS AGREEMENT FROM TIME TO TIME. THE MOST RECENT VERSION OF THIS AGREEMENT SHALL ALWAYS BE AVAILABLE ON THE INTERNET AT [HTTP://WWW.SCOSCHE.COM](http://www.scosche.com) AND THE MOST RECENT VERSION SHALL SUPERSEDE ANY AND ALL OTHER VERSIONS OF THIS AGREEMENT. SCOSCHE INDUSTRIES RESERVES THE RIGHT TO CHANGE OR MODIFY THIS AGREEMENT OR ANY OTHER COMPANY POLICIES RELATED TO USE OF THE SOFTWARE AT ANY TIME AND AT ITS SOLE DISCRETION BY POSTING REVISIONS ON THE INTERNET AT [HTTP://WWW.SCOSCHE.COM](http://www.scosche.com). CONTINUED USE OF THE SOFTWARE FOLLOWING THE POSTING OF THESE CHANGES OR MODIFICATIONS WILL CONSTITUTE ACCEPTANCE OF SUCH CHANGES OR MODIFICATIONS. PLEASE READ THIS DOCUMENT CAREFULLY BEFORE ACCEPTING THESE TERMS AND USING THIS SOFTWARE. IF YOU DO NOT AGREE WITH THE TERMS AND CONDITIONS OF THIS AGREEMENT, YOU SHOULD REJECT THEM BY NOT DOWNLOADING THE SOFTWARE. References in this Agreement to "you" or "your" refer to both you and any person or entity on whose behalf you act, if any.

1. Grant of License. Subject to the terms and conditions of this Agreement, Scosche Industries hereby grants to you a personal, non-transferable and non-exclusive license to install and use the Software on your iPhone® or iPod® device for the purposes of your own personal health and fitness needs.
2. Software Use Restrictions. You shall not sublicense, distribute, hypothecate, lease, loan or otherwise convey the Software or any portion thereof to anyone, and under no circumstance may you use or allow the use of the Software in any manner other than as expressly set forth herein. You shall not modify the Software, incorporate the Software in whole or in part in any other product or create derivative works based on all or part of the Software. You shall not remove any copyright, trademark, proprietary rights, disclaimer or warning notice included on or embedded in any part of the Software. You shall not use the Software in connection with a service bureau, time sharing, or fee-for service arrangement with third parties. Except to the extent permitted by applicable local law, you shall not reverse assemble, decompile or disassemble or otherwise reverse engineer any portion of the Software. If you dispose of any media embodying Software, you will ensure that you have completely erased or otherwise destroyed any Software stored on such media. You must comply with applicable third party terms of agreement when using the Software. THE SOFTWARE IS NOT INTENDED FOR USE IN ANY SITUATION IN WHICH THE FAILURE OF THE SOFTWARE COULD LEAD TO DEATH OR BODILY INJURY OF ANY TYPE.
3. Acceptable Use. Use of the Software and any of your information transmitted in connection with the Software is limited to your own personal health and fitness needs. In no event may the Software be used in a manner that (a) harasses, abuses, threatens, defames or otherwise infringes or violates the rights of any other party; (b) is unlawful, fraudulent or deceptive; (c) uses technology or other means to access Scosche Industries' proprietary information that is not authorized by Scosche Industries; (d) uses or launches any automated system to access Scosche Industries' website or computer systems; (e) attempts to introduce viruses or any other malicious computer code that interrupts, destroys or limits the functionality of any computer software, hardware or telecommunications equipment; (f) attempts to gain unauthorized access to Scosche Industries' computer network or user accounts; (g) encourages conduct that would constitute a criminal offense, or would give rise to civil liability; or (h) violates this Agreement. Scosche Industries reserves the right, in its sole discretion, to terminate this Agreement and request that you remove the Software for any reason, including but not limited to Scosche Industries' reasonable conclusion that you have violated this Agreement.
4. Copying Restrictions. You may copy the Software onto your iPhone or iPod device, and you may make one (1) copy of the Software for backup or archival purposes. You agree that (i) your use and possession of such copies shall be solely under the terms and conditions of this Agreement, and (ii) you shall place the same proprietary and copyright notices and legends on all such copies as included by Scosche Industries on any media embodying an authorized copy of the Software originally provided by Scosche Industries. Except as described in this paragraph, you are not permitted to copy the Software.
5. Disclosure Restrictions. You acknowledge that the Software, including the source code for the Software and any information derived therefrom, constitutes a valuable trade secret of Scosche Industries. You shall not disclose such materials to anyone.
6. Ownership of Software. You agree and acknowledge that (i) the Software is licensed to you, not sold, and Scosche Industries transfers no ownership interest in the Software, in the intellectual property in any Software or in any Software copy, to you under this Agreement or otherwise, (ii) that Scosche Industries and its licensors reserve all rights not expressly granted to you hereunder, (iii) Scosche Industries or its licensors own the Software (including, but not by way of limitation, any images, algorithms, photographs, animations, video, audio, music and text incorporated in the Software), and (iv) the Software is protected by United States Copyright Law and international treaties relating to protection of copyright. The term "Software" includes, and this Agreement will cover, any updates, upgrades or bug fixes for the Software provided to you.
7. Transfer Restrictions. You may transfer the Software and all licenses and rights in the Software granted to you under this Agreement to a third party provided that: (i) such transferee agrees to accept the terms and conditions of this Agreement, and (ii) you also transfer all Software, including all copies thereof, to such transferee. Except as provided in this Section, you may not transfer or assign this Agreement or any of your rights or obligations under this Agreement, in whole or in part.
8. Export Restrictions. You may not export or reexport any Software except in full compliance with all United States laws and regulations, executive orders and the like, including in particular the Export Administration Regulations of the U.S. Department of Commerce. Without limitation of the foregoing, no Software may be exported or reexported into (or to a national or resident of) any country to which the U.S. embargoes goods, or to anyone on the U.S. Treasury Department's list of Specially Designated Nationals and Blocked Persons or the U.S. Commerce Department's Denied Persons List. You represent and warrant that (i) you are not located in a country that is subject to a U.S. Government embargo, or that has been designated by the U.S. Government as a "terrorist supporting" country; and (ii) you are not listed on any U.S. Government list of prohibited or restricted parties.
9. Enforcement of Terms; Termination. If you fail to fulfill any of your obligations under this Agreement, this Agreement will automatically terminate, and Scosche Industries and/or its licensors may pursue all available legal remedies available to them. You agree that Scosche Industries' licensors referenced in the Software are third-party beneficiaries of this Agreement, and may enforce this Agreement as it relates to their intellectual property. Sections 2-10 and 12-21 shall survive any termination or expiration of this Agreement.

(cont'd)

SCOSCHE® myTREK™ App - Legal End User License Agreement (cont'd)

10. U. S. Government Users. Pursuant to the policy stated at 48 CFR 227.7202-1, U.S. Government users acknowledge that (i) the Software is commercial computer software, (ii) this Agreement embodies the licenses customarily used by Scosche Industries for licenses in Software granted to the public, and (iii) the licenses set forth herein shall apply to all possession, use and duplication of the Software by the Government, except to the extent which such licenses are inconsistent with Federal procurement law. Contractor/manufacturer is Scosche Industries.

11. Assumption of Risk. You acknowledge that your health and fitness activities involve risks, which may involve risk of bodily injury or death, and that you assume those risks. You should consult a licensed physician prior to beginning any health or fitness program that you undertake, and you acknowledge that Scosche Industries has advised you of the necessity for obtaining such consultations. In addition, the Software should not be used by pregnant women or individuals under age 18. The Software is a source of information, but it does not provide medical advice. In no event shall Scosche Industries be liable for any death or bodily injury that you suffer, or that you cause to any third party, in connection with your use of the Software or any form of fitness training, exercise or other activity you undertake in connection with your use of the Software.

12. Disclaimer of Warranty. SCOSCHE INDUSTRIES PROVIDES THE SOFTWARE TO YOU "AS IS", WITH ALL FAULTS, AND WITHOUT WARRANTY OF ANY KIND, EXPRESS, STATUTORY, IMPLIED OR OTHERWISE, INCLUDING WITHOUT LIMITATION ANY WARRANTY OF MERCHANTABILITY, FITNESS FOR A PARTICULAR PURPOSE, OR NON-INFRINGEMENT. SCOSCHE INDUSTRIES MAKES NO REPRESENTATION OR WARRANTY THAT THE SOFTWARE IS ACCURATE, COMPLETE OR UP-TO-DATE. NO ORAL OR WRITTEN INFORMATION OR ADVICE GIVEN BY ANY SCOSCHE INDUSTRIES EMPLOYEE, REPRESENTATIVE OR DISTRIBUTOR SHALL CREATE A WARRANTY FOR THE SOFTWARE, AND YOU MAY NOT RELY ON ANY SUCH INFORMATION OR ADVICE. SCOSCHE INDUSTRIES' LICENSORS EXPLICITLY DISCLAIM ANY AND ALL WARRANTIES WITH RESPECT TO THE SOFTWARE.

13. Limitation of Liability. IN NO EVENT SHALL SCOSCHE INDUSTRIES OR ITS LICENSORS BE LIABLE TO YOU FOR ANY SPECIAL, CONSEQUENTIAL, PUNITIVE, EXEMPLARY, INCIDENTAL OR INDIRECT DAMAGES OF ANY KIND (INCLUDING WITHOUT LIMITATION THE COST OF COVER, DAMAGES ARISING FROM LOSS OF DATA, USE, PROFITS OR GOODWILL), WHETHER OR NOT SCOSCHE INDUSTRIES HAS BEEN ADVISED OF THE POSSIBILITY OF SUCH LOSS, HOWEVER CAUSED AND ON ANY THEORY OF LIABILITY ARISING OUT OF THIS AGREEMENT. THESE LIMITATIONS SHALL APPLY NOTWITHSTANDING THE FAILURE OF ESSENTIAL PURPOSE OF ANY LIMITED REMEDY. SCOSCHE INDUSTRIES' MAXIMUM AGGREGATE LIABILITY ARISING OUT OF THIS AGREEMENT AND/OR YOUR USE OR POSSESSION OF THE SOFTWARE, INCLUDING WITHOUT LIMITATION ANY CLAIMS IN TORT (INCLUDING NEGLIGENCE), CONTRACT, BREACH OF WARRANTY, STRICT LIABILITY OR OTHERWISE, AND FOR ANY AND ALL CLAIMS COMBINED, WILL NOT EXCEED THE LESSER OF (A) \$10; OR (B) THE FEE YOU PAID FOR YOUR LICENSE TO THE SOFTWARE.

14. Governing Law. This Agreement shall be governed by and interpreted in accordance with the laws of the State of California, excluding its choice of law rules. The United Nations Convention on Contracts for the International Sale of Goods shall not apply.

15. Disputes. A party shall not seek relief from a court with respect to any dispute arising in connection with this Agreement (except for any application for urgent equitable relief) unless such dispute has first been referred to voluntary mediation, and, if such mediation is not successful, has been submitted to arbitration conducted by a panel of three arbitrators sitting in Ventura, California. Each party shall choose one arbitrator and those two shall choose the third. The arbitration shall be conducted in accordance with the Commercial Arbitration Rules of the American Arbitration Association and the decision of the arbitrators shall be binding and enforceable in any court of competent jurisdiction. The arbitrators shall have no power to award punitive damages or any damages inconsistent with this Agreement or measured other than by the actual losses suffered by the parties.

16. Complete Agreement; Waiver; Severability. This Agreement supersedes all proposals, oral or written, all negotiations, conversations, discussions and all past course of dealing between you and Scosche Industries relating to the Software or the terms of its license to you, and may only be modified by Scosche Industries in the manner identified above. In the event any term of this Agreement is held by a court of competent jurisdiction not to be enforceable, the remaining terms shall survive and be enforced to the maximum extent permissible by law. No waiver of any right or obligation contained herein shall be given except in writing signed by the party against whom the waiver is sought to be enforced. If any of the provisions of this Agreement are held to be invalid under any applicable statute or rule of law, they shall be severed from this Agreement and the remaining provisions of this Agreement shall be interpreted so as best to reasonably effect the intent of the parties. The parties further agree to replace any such invalid or unenforceable provisions with valid and enforceable provisions designed to achieve, to the extent possible, the business purposes and intent of such invalid or unenforceable provisions.

17. Consent to Electronic Contracting. You agree that execution of this Agreement may occur by your manifesting your acceptance of it when you downloaded and used the Software, and that no signature on a paper copy of this Agreement is required in order to form a binding contract.

18. Acknowledgements. You and Scosche Industries acknowledge that this Agreement is between you and Scosche Industries only, and not with Apple, Inc. ("Apple"). You and Scosche Industries further acknowledge that Apple has no obligation whatsoever to furnish any maintenance and support services with respect to the Software. In the event of any failure of the Software to conform to any applicable warranty, you may notify Apple, and Apple will refund the purchase price for the Software to you. To the maximum extent permitted by applicable law, Apple will have no other warranty obligation whatsoever with respect to the Software. Scosche Industries and you acknowledge that Apple is not responsible for addressing any claims by you or any third party relating to the Software or your possession and/or use of the Software, including, but not limited to: (i) product liability claims; (ii) any claim that the Software fails to conform to any applicable legal or regulatory requirement; and (iii) claims arising under consumer protection or similar legislation. Scosche Industries and you acknowledge that, in the event of any third party claim that the Software or your possession and use of the Software infringes that third party's intellectual property rights, Apple will not be responsible for the investigation, defense, settlement and discharge of any such intellectual property infringement claim. Should the Software be found to infringe any intellectual property rights of a third party, your sole remedy shall be either to cease using the Software or to use a non-infringing version of the Software should Scosche Industries choose to provide you with such a non-infringing version. Scosche Industries and you acknowledge and agree that Apple and Apple's subsidiaries are third party beneficiaries of this Agreement and upon your acceptance of the terms and conditions of this Agreement, Apple will have the right (and will be deemed to have accepted the right) to enforce this Agreement against you as a third party beneficiary thereof.

(cont'd)

SCOSCHE® myTREK™ App - Legal End User License Agreement (cont'd)

19. Incorporation of Apple, Inc.'s Licensed Application End User License Agreement. This Agreement incorporates by reference the Licensed Application End User License Agreement (the "LAEULA") published by Apple (located online at <http://www.apple.com/legal/itunes/appstore/dev/stdeula/>). For purposes of this Agreement, the Software is considered the "Licensed Application" as defined in the LAEULA and Scosche Industries is considered the "Application Provider" as defined in the LAEULA. If any terms of this Agreement conflict with the terms of the LAEULA, the terms of this Agreement shall control.

20. Contact Information. Scosche Industries may be contacted at Scosche Industries, 1550 Pacific Avenue, Oxnard, CA 93033, (800) 363-4490 Toll Free, (805) 486-4450 Local, and (805) 486-9996 Fax for any end-user questions, complaints, or claims with respect to the Software.

21. Privacy Disclosure. Scosche Industries may use analytics technology to track anonymous traffic data about the use of the Software. This data does not include any personally identifiable information of you, the user. Some of the analytics technology described in this paragraph is provided to Scosche Industries by Google, Inc. ("Google"). Under the Google Analytics Terms of Service, Google and its subsidiaries have the right to retain and use the anonymous traffic data collected by the Google Analytics service from users of the Software. Use of such data is subject to the Google Privacy Policy located at <http://www.google.com/privacy.html>.

LIMITED WARRANTY

Scosche Industries Inc. warrants this product to be free from defects in material and workmanship for a period of 1 year from purchase. This Scosche product is sold with the understanding that the purchaser has independently determined the suitability of this product. This warranty is offered to the original purchaser of the product only. This warranty does not cover the product if physically damaged, subject to negligence or misuse, abuse, alteration, accident, or an act of GOD. This warranty does not apply to product which has water or physically damaged by accident or which has been misused, disassembled or altered.

The original dated sales slip or proof of purchase will establish warranty eligibility. If the product should prove defective within the warranty period, return the product with proof of purchase to Scosche Industries Inc. Scosche, at its option, will replace or repair the product free of charge and return the product postage paid.

In no event shall Scosche Industries, Inc. be responsible for claims beyond the replacement value of the defective product, or in any way be liable or responsible for consequential or incidental damages. No express warranties and no implied warranties, whether for fitness or any particular use or otherwise, except as set forth above (which is made expressly in lieu of all other warranties) shall apply to products sold by Scosche. Scosche Industries cannot be held responsible for discrepancies/inconsistencies that may occur due to automotive manufacturing changes or option.